

STALL
20'0" X 20'0"

STALL
20'0" X 20'0"

WALL MADE UP OF BAMBOO
MAT PLASTERED WITH P.O.P.
ON BOTH SIDES

WALL MADE UP OF BAMBOO
MAT PLASTERED WITH P.O.P.
ON BOTH SIDES

PLAN

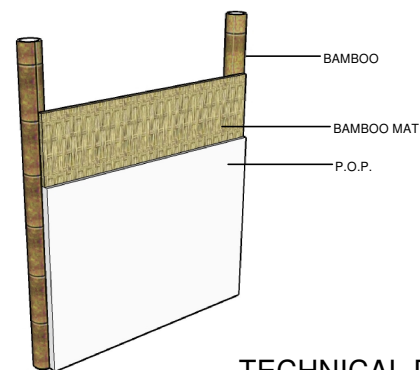

TECHNICAL DETAILS

WALL MADE UP OF BAMBOO
MAT PLASTERED WITH P.O.P.
ON BOTH SIDES

THACHED ROOFING OVER
BAMBOO TRUSSES.

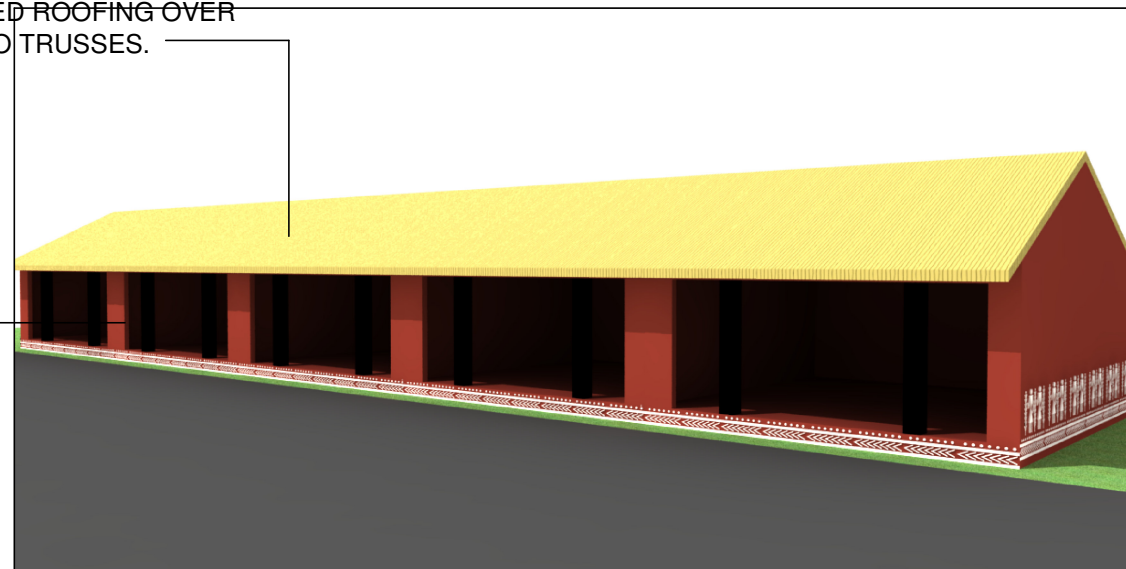

▽APEX LEVEL(+13'-0")

▽LOWER ROOF
LEVEL(+8'-0")

▽PLINTH LEVEL(+1'-0")

△GROUND LEVEL(+0'-0")